

Building Data Summary

Project ID:	*****8
Location:	***** Oakland, CA
Scope of Work:	Concrete
Date:	*****



Construction Estimation Services

Item #	Ref. Sheet #	Item Description	Unit	Quantity	Wastage	Quantity w/ Wastage	Unit Material Cost	Total Material Cost	Unit Manhour	Hourly Wage	Unit Labor Cost	Total Labor Cost	Sub Cost	Total Trade Cost
DIVISION 01 GENERAL REQUIREMENTS														
1		Supervision and Coordination	LS	1	0%	1	\$ -	\$ -	0.000	\$ -	\$ -	\$ -	\$ -	\$ -
2		Submittals and Shop drawings	LS	1	0%	1	\$ -	\$ -	0.000	\$ -	\$ -	\$ -	\$ -	\$ -
3		Final Cleaning	LS	1	0%	1	\$ -	\$ -	0.000	\$ -	\$ -	\$ -	\$ -	\$ -
4		Mobilization Costs	LS	1	0%	1	\$ -	\$ -	0.000	\$ -	\$ -	\$ -	\$ -	\$ -
5		Temporary Control & Facilities	LS	1	0%	1	\$ -	\$ -	0.000	\$ -	\$ -	\$ -	\$ -	\$ -
Subtotal (General Requirements)														\$ -

DIVISION 02- SITE WORK/ EXISTING CONDITIONS														
Site Work														
6		Asphalt Paving	SF	690	0%	690	\$ 5.35	\$ 3,691.50	0.048	\$ 68.00	\$ 3.26	\$ 2,252.16	\$ 5,943.66	
7		Bollard Footing (20" Dia) Isolated Bollard Footing (44 EA) (4'-0" H)	CY	14.22	0%	14	\$ 268.65	\$ 3,820.20	2.850	\$ 68.00	\$ 193.80	\$ 2,755.84	\$ 6,576.04	
8		Fence Footing (16" Dia) Sonotube Footing (32 EA) (3'-6" H)	CY	5.78	0%	6	\$ 268.65	\$ 1,552.80	2.850	\$ 68.00	\$ 193.80	\$ 1,120.16	\$ 2,672.96	
9		Concrete Pad (4" Thick) Transformer Pad (82 SF)	CY	1.01	0%	1	\$ 268.65	\$ 271.34	2.850	\$ 68.00	\$ 193.80	\$ 195.74	\$ 467.07	
10		(4" Thick) Concrete Pad Under Generators (355 SF)	CY	4.38	0%	4	\$ 268.65	\$ 1,176.69	2.850	\$ 68.00	\$ 193.80	\$ 848.84	\$ 2,025.53	
11		Concrete Sidewalk (4" Thick) Concrete Sidewalk (1740 SF)	CY	21.48	0%	21	\$ 268.65	\$ 5,770.60	2.850	\$ 68.00	\$ 193.80	\$ 4,162.82	\$ 9,933.43	
12		Slab On Grade (6" Thick) Concrete Slab (2480 SF)	CY	45.92	0%	46	\$ 268.65	\$ 12,336.41	2.850	\$ 68.00	\$ 193.80	\$ 8,899.30	\$ 21,235.70	
13		Foundation Excavation @ Footing	CY	250.53	0%	251	\$ -	\$ -	0.850	\$ 60.00	\$ 51.00	\$ 12,777.03	\$ 12,777.03	
14		(4" Thick) Of (3/4" Dia) Clean Graded Rock	SF	5326	0%	5326	\$ 1.32	\$ 7,030.32	0.020	\$ 55.00	\$ 1.10	\$ 5,858.60	\$ 12,888.92	
Subtotal (Site Work/ Existing Conditions)														\$ 74,520

DIVISION 03- CONCRETE														
Foundation														
15		Isolated Footing F36 (3'-0"x3'-0"x18") Rinf. Concrete Footing - 2 EA (3) #6 EA Way (B)	CY	1	0%	1	\$ 298.65	\$ 298.65	2.850	\$ 85.00	\$ 242.25	\$ 242.25	\$ 540.90	
16		Isolated Concrete Footing	CY	1										
17		Reinforced w/ (3) #6 Ea Way Bottom (36 LF)	Lbs.	55										
18		F60 (5'-0"x5'-0"x18") Rinf. Concrete Footing - 3 EA (5) #6 EA Way (B)	CY	4.16	0%	4	\$ 298.65	\$ 1,242.38	2.850	\$ 85.00	\$ 242.25	\$ 1,007.76	\$ 2,250.14	
19		Isolated Concrete Footing	CY	4.16										
20		Reinforced w/ (5) #6 Ea Way Bottom (150 LF)	Lbs.	226										
21		F72 (6'-0"x6'-0"x18") Rinf. Concrete Footing - 1 EA (6) #6 EA Way (B)	CY	2	0%	2	\$ 298.65	\$ 597.30	2.850	\$ 85.00	\$ 242.25	\$ 484.50	\$ 1,081.80	
22		Isolated Concrete Footing	CY	2										
23		Reinforced w/ (6) #6 Ea Way Bottom (72 LF)	Lbs.	109										
24		F78 (6'-6"x6'-6"x18") Rinf. Concrete Footing - 1 EA (7) #6 EA Way (B)	CY	2.35	0%	2	\$ 298.65	\$ 701.83	2.850	\$ 85.00	\$ 242.25	\$ 569.29	\$ 1,271.12	
25		Isolated Concrete Footing	CY	2.35										
26		Reinforced w/ (7) #6 Ea Way Bottom (91 LF)	Lbs.	137										
27		F102 (8'-6"x8'-6"x18") Rinf. Concrete Footing - 1 EA (9) #6 EA Way (B)	CY	4.02	0%	4	\$ 298.65	\$ 1,200.57	2.850	\$ 85.00	\$ 242.25	\$ 973.85	\$ 2,174.42	
28		Isolated Concrete Footing	CY	4.02										
29		Reinforced w/ (9) #6 Ea Way Bottom (153 LF)	Lbs.	230										
30		F108 (9'-0"x9'-0"x18") Rinf. Concrete Footing - 2 EA (8) #6 EA Way (B)	CY	9	0%	9	\$ 298.65	\$ 2,687.85	2.850	\$ 85.00	\$ 242.25	\$ 2,180.25	\$ 4,868.10	
31		Isolated Concrete Footing	CY	9										
32		Reinforced w/ (9) #6 Ea Way Bottom (288 LF)	Lbs.	433										
33		Continuous Footing CF72 (6'-0"x18") Rinf. Concrete Continuous Footing - 93 LF (12) #6 Long Bars (6) Top & Bottom & #6 Trans Bar @ 12" O.C	CY	31	0%	31	\$ 298.65	\$ 9,258.15	2.850	\$ 85.00	\$ 242.25	\$ 7,509.75	\$ 16,767.90	
34		Continuous Concrete Footing	CY	31										
35		Reinforced w/ (12) #6 Long Bars (6) Top & Bottom (1116 LF)	Lbs.	1677										
36		Reinforced w/ #6 Trans Bar @ 12" O.C (1395 LF)	Lbs.	2096										
37		CF132 (11'-0"x18") Rinf. Concrete Continuous Footing - 161 LF (42) #8 Long Bars (B), (8) #7 Long Bars (T) & #7 Bars @ 18" O.C T&B	CY	98.39	0%	98	\$ 298.65	\$ 29,384.17	2.850	\$ 85.00	\$ 242.25	\$ 23,834.98	\$ 53,219.15	
38		Continuous Concrete Footing	CY	98.39										
39		Reinforced w/ (42) #8 Long Bars Bottom (6762 LF)	Lbs.	18055										
40		Reinforced w/ (8) #7 Long Bars Top (1288 LF)	Lbs.	2633										
41		Reinforced w/ #7 Trans Bar @ 18" O.C (2684 LF)	Lbs.	5487										
42		CF156 (13'-0"x18") Rinf. Concrete Continuous Footing - 105 LF (50) #8 Long Bars Bottom, (10) #7 Long Bars Top & #7 Trans Bars @ 18" O.C T&B	CY	75.84	0%	76	\$ 298.65	\$ 22,649.62	2.850	\$ 85.00	\$ 242.25	\$ 18,372.24	\$ 41,021.86	
43		Continuous Concrete Footing	CY	75.84										
44		Reinforced w/ (50) #8 Long Bars Bottom (5250 LF)	Lbs.	14018										
45		Reinforced w/ (10) #7 Long Bars Top (1050 LF)	Lbs.	2147										
46		Reinforced w/ #7 Trans Bar @ 18" O.C (2030 LF)	Lbs.	4150										
47		Slab On Grade SG8 (8" Thick) Rinf. Concrete Slab - 3870 SF #5 @ 18" O.C (B) EA Way	CY	95.56	0%	96	\$ 298.65	\$ 28,538.99	2.850	\$ 85.00	\$ 242.25	\$ 23,149.41	\$ 51,688.40	
48		Slab Concrete	CY	95.56										
49		Reinforced W/ #5 @ 18" O.C Each Way Bottom (2580 LF)	Lbs.	2691										
50		SG18 (18" Thick) Concrete Slab - 1456 SF #4 @ 12" O.C EA Way (T&B)	CY	80.89	0%	81	\$ 298.65	\$ 24,157.80	2.850	\$ 85.00	\$ 242.25	\$ 19,595.60	\$ 43,753.40	
51		Slab Concrete	CY	80.89										
52		Reinforced W/ #4 @ 12" O.C Each Way Top & Bottom (2912 LF)	Lbs.	1946										
Subtotal (Concrete)														\$ 218,637

DIVISION 07- THERMAL & MOISTURE PROTECTION														
Foundation														
53	S-2	(10 MIL) Vapor Barrier	SF	5326	0%	5326	\$ 0.92	\$ 4,899.92	0.015	\$ 62.00	\$ 0.93	\$ 4,953.18	\$ 9,853.10	
Subtotal (Thermal & Moisture Protection)														\$ 9,853

													PROJECTED COST	\$ 303,011
													INSURANCE	\$ 9,090
													CONTINGENCY	\$ 15,151
													OVERHEAD AND PROFIT	\$ 45,452

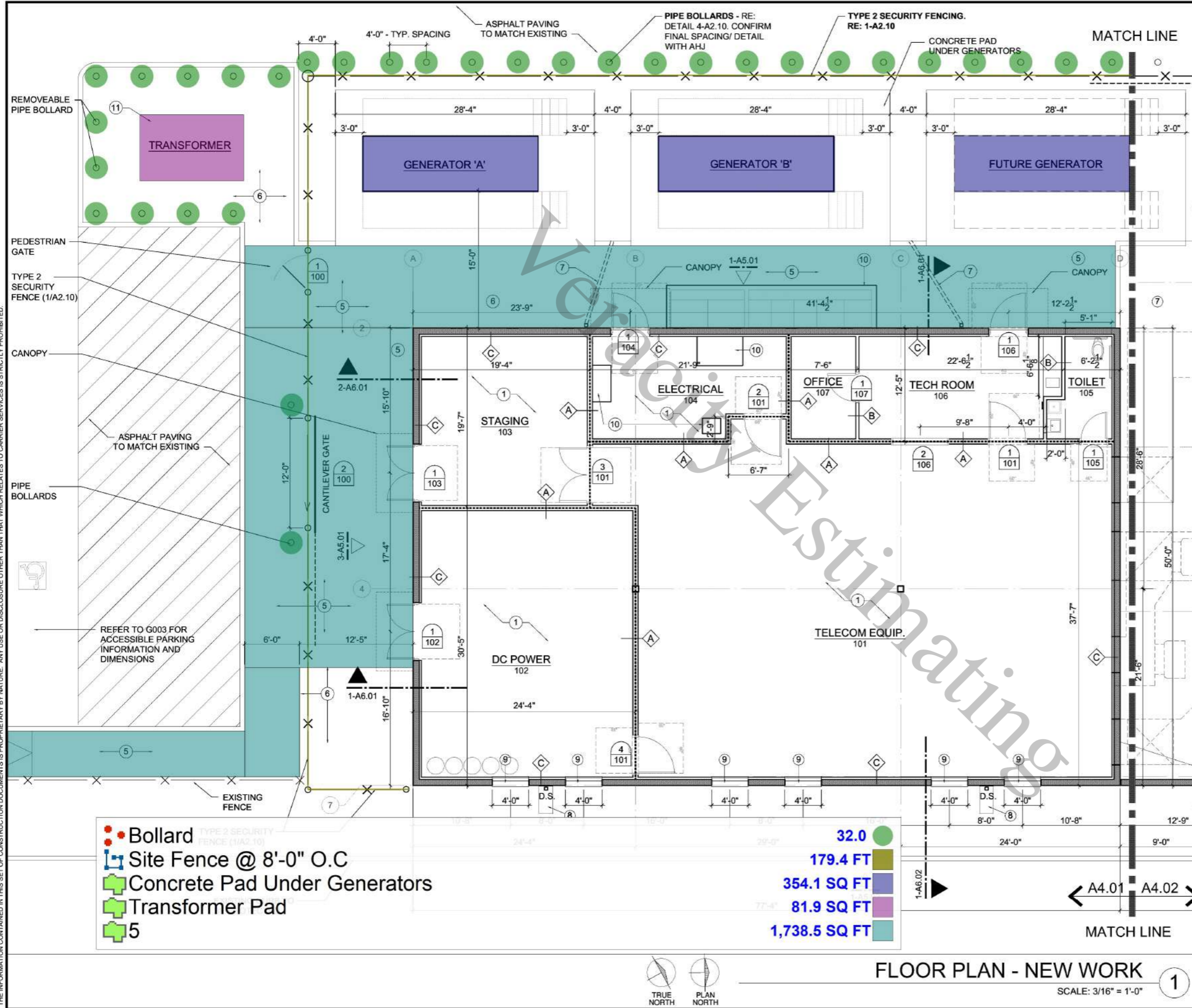

FS&L Architects
ARCHITECTS/PLANNERS

1600 Genessee St., Suite 837, Kansas City, MO 64102
Tel: 816-421-4133

GENERAL PLAN NOTES:

1. ALL INTERIOR WALL DIMENSIONS TO THE CENTER-LINE OF WALL.

PLAN LEGEND

- 2 HOUR RATED ASSEMBLY
- NEW PRECAST CONCRETE WALL ASSEMBLY, 2 HOUR RATED
- NEW GYPSUM BOARD ON METAL STUDS WALL ASSEMBLY
- X X TYPE 2 SECURITY FENCING: IMPASSE II HIGH SECURITY STEEL PALISADE FENCING, GAUNTLET MODEL (BLACK)

KEYNOTES

- 1 WALLS DESIGNATED FOR ELECTRICAL PANELS AND ASSOCIATED ELECTRICAL EQUIPMENT TO HAVE LAYER OF 3/4" FIRE-RATED PLYWOOD
- 2 COLD AISLE CONTAINMENT SYSTEM AT AISLES TO BE TATE OR SIM/ EQUAL W/ SLIDING DOORS.
- 3 LOUVERS AND LOUVER DOORS TO BE AIROLITE OR APPROVED EQUAL, 4" DEEP, 0.081-INCH THICK FOR BLADES AND FRAMES. KYNAR 500 FINISH.
- 4 PROVIDE DOORS WITH MATCHING LOUVER BLADES. INSTALL PLATES ON INTERIOR LATCH SIDE OF DOORS TP PREVENT REACH-AROUND ACCESS.
- 5 4" CONCRETE SIDEWALK OVER 6" CLEAN CRUSHED GRAVEL. SUBGRADE TO BE COMPACTED TO 95% STANDARD PROCTOR DENSITY. CONTROL JOINTS AT 6'-0" MAX. EXPANSION JOINTS AT 30'-0" MAX.
- 6 4" DEEP STONE AGGREGATE OVER VEGETATION BARRIER.
- 7 3" UNDERGROUND PIPE FOR DOWNSPOUT EXTENSION THROUGH CONCRETE WALKWAY TO ASPHALT
- 8 INSTALL CONCRETE SPLASH-BLOCK TO DIRECT WATER AWAY FROM BUILDING
- 9 LOUVERS PER MECHANICAL. RE: 3-A6.10
- 10 4" CONCRETE HOUSEKEEPING PAD AT ELECTRICAL EQUIPMENT. COORDINATE WITH ELECTRICAL FOR REQUIREMENTS (SIZE, ANCHORAGE)
- 11 PROPOSED TRANSFORMER LOCATION, FINAL REQUIREMENTS DETERMINED BY AHJ AND UTILITY COMPANY



REVISIONS			
REV.	DATE	DESCRIPTION	INITIALS
	2/12/2024	BID DRAWINGS	

Estimating

BID DRAWINGS
NOT FOR CONSTRUCTION

02/12/2024

I HEREBY CERTIFY THAT THESE PLANS WERE PREPARED BY ME AND UNDER MY DIRECT SUPERVISION AND THAT I AM DULY REGISTERED ENGINEER UNDER THE LAWS OF THE STATE OF CALIFORNIA



SHEET TITLE
FLOOR PLAN SOUTH

SHEET NUMBER
A4.01

FLOOR PLAN - NEW WORK
SCALE: 3/16" = 1'-0" 1

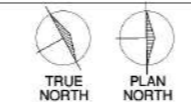

THE INFORMATION CONTAINED IN THIS SET OF CONSTRUCTION DOCUMENTS IS PROPRIETARY BY NATURE. ANY USE OR DISCLOSURE OTHER THAN THAT WHICH RELATES TO CARRIER SERVICES IS STRICTLY PROHIBITED.

- Bollard
- Site Fence @ 8'-0" O.C
- Concrete Pad Under Generators
- Transformer Pad
- 5

- 32.0
- 179.4 FT
- 354.1 SQ FT
- 81.9 SQ FT
- 1,738.5 SQ FT

2/13/2024 8:31:30 PM THE INFORMATION CONTAINED IN THIS SET OF CONSTRUCTION DOCUMENTS IS PROPRIETARY IN NATURE. ANY USE OR DISCLOSURE OTHER THAN THAT WHICH RELATES TO CARRIER SERVICES IS STRICTLY PROHIBITED.

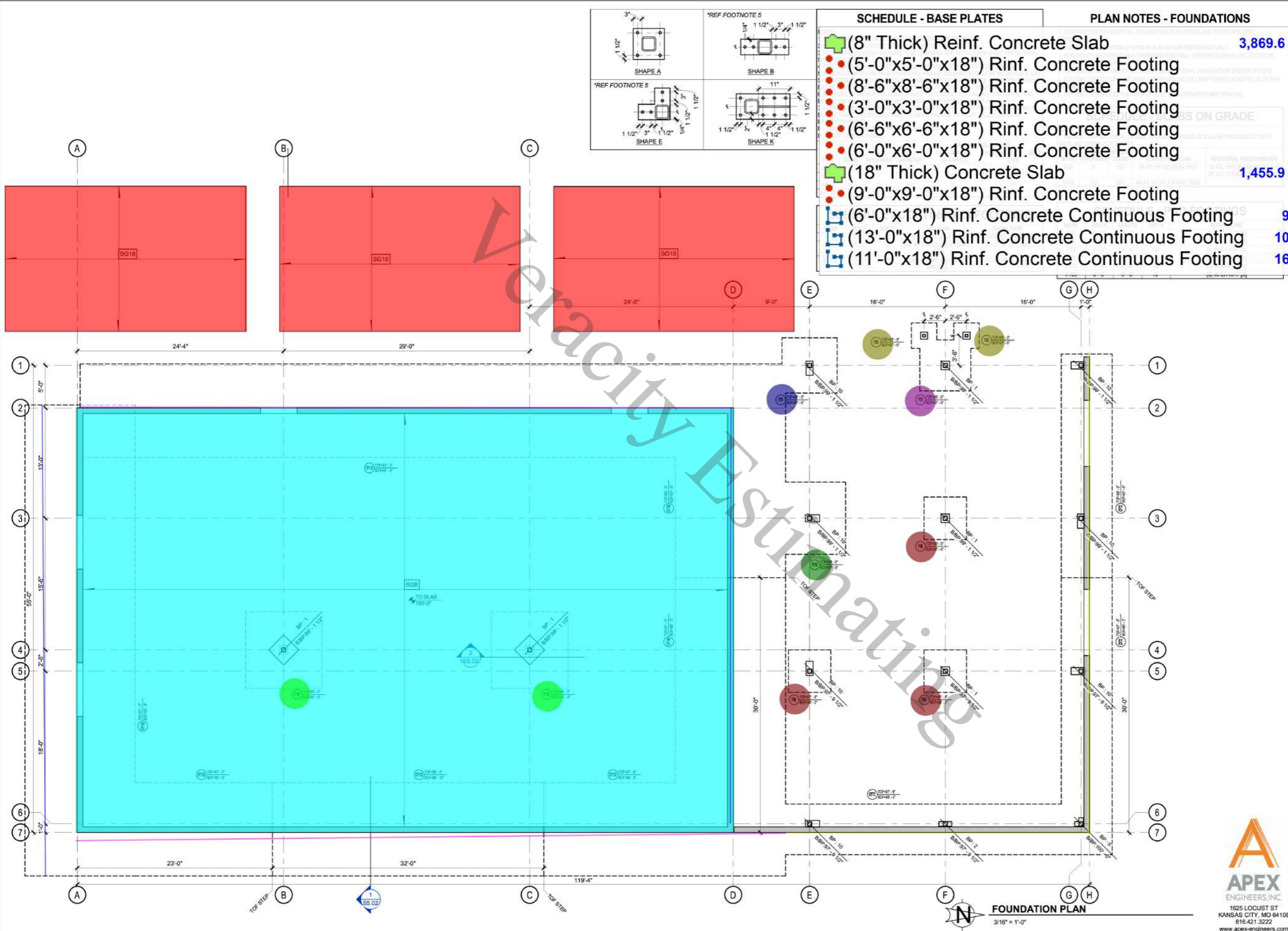

NATIONAL POWER
We Deliver Reliability and Resilience.

InSite Group
DEDICATION. DESIRE. INTEGRITY.

AS CITY - (816) 228-3377
Well Rd., Ste. B, Lee's Summit, MO 64064
PLAND - (503) 222-2044
We, Ste. 30, Gladstone, OR 97027
PROJECT NUMBER: 23-7579-0

REVISIONS		
DESCRIPTION	DATE	INITIALS
BID DRAWINGS		

BID DRAWINGS
NOT FOR CONSTRUCTION

DATE: _____

I HEREBY CERTIFY THAT THESE PLANS WERE PREPARED BY ME AND UNDER MY DIRECT SUPERVISION AND THAT I AM DULY REGISTERED ENGINEER UNDER THE LAWS OF THE STATE OF CALIFORNIA

SITE INFORMATION

VERACITY ESTIMATING
Construction Estimation Services

SHEET TITLE
FOUNDATION PLAN

SHEET NUMBER
S2.00

APEX ENGINEERS, INC.
1625 LOCUST ST
KANSAS CITY, MO 64108
816.421.3222
www.apex-engineers.com