

Building Data Summary



Project ID:	*****
Location:	*****
Scope of Work:	Roofing
Date:	01/12/2024

Item #	Ref. Sheet #	Item Description	Unit	Quantity	Wastage	Quantity w/ Wastage	Unit Material Cost	Total Material Cost	Unit Manhour	Hourly Wage	Unit Labor Cost	Total Labor Cost	Sub Cost	Total Trade Cost
<b>DIVISION 01 GENERAL REQUIREMENTS</b>														
1		Supervision and Coordination	LS	1	0%	1	\$ -	\$ -	0.000	\$ -	\$ -	\$ -	\$ -	\$ -
2		Submittals and Shop drawings	LS	1	0%	1	\$ -	\$ -	0.000	\$ -	\$ -	\$ -	\$ -	\$ -
3		Final Cleaning	LS	1	0%	1	\$ -	\$ -	0.000	\$ -	\$ -	\$ -	\$ -	\$ -
4		Mobilization Costs	LS	1	0%	1	\$ -	\$ -	0.000	\$ -	\$ -	\$ -	\$ -	\$ -
5		Temporary Control & Facilities	LS	1	0%	1	\$ -	\$ -	0.000	\$ -	\$ -	\$ -	\$ -	\$ -
<b>Subtotal (General Requirements)</b>													\$ -	\$ -
<b>DIVISION 07- THERMAL &amp; MOISTURE PROTECTION</b>														
<b>Roofing</b>														
<b>Roofing Type 1</b>														
6		KYNAR Finished Standing Seam Metal Roof	SF	7095	0%	7095	\$ -	\$ -	0.000	\$ -	\$ -	\$ -	\$ -	\$ -
7		30# Roof Felt	SF	7095	0%	7095	\$ -	\$ -	0.000	\$ -	\$ -	\$ -	\$ -	\$ -
8		ICE & Water Shield	SF	1920	0%	1920	\$ -	\$ -	0.000	\$ -	\$ -	\$ -	\$ -	\$ -
9		Bat Insulation	SF	7095	0%	7095	\$ -	\$ -	0.000	\$ -	\$ -	\$ -	\$ -	\$ -
<b>Roofing Type 2</b>														
10		Fully Adhered Single Ply Membrane Roofing System (Gray In Color)	SF	2415	0%	2415	\$ -	\$ -	0.000	\$ -	\$ -	\$ -	\$ -	\$ -
11		Polyisocyanurate Insulation	SF	2415	0%	2415	\$ -	\$ -	0.000	\$ -	\$ -	\$ -	\$ -	\$ -
<b>Gutter &amp; Downspouts</b>														
12		Chain Rain Leader	EA	18	0%	18	\$ -	\$ -	0.000	\$ -	\$ -	\$ -	\$ -	\$ -
13		Custom Square Aluminum Downspouts	LF	265	0%	265	\$ -	\$ -	0.000	\$ -	\$ -	\$ -	\$ -	\$ -
14		(6" Dia) Round KYNAR Finishes "Weathered Copper" Gutter	LF	255	0%	255	\$ -	\$ -	0.000	\$ -	\$ -	\$ -	\$ -	\$ -
<b>Fascia &amp; Soffit</b>														
15		(3/8" Thick) Steel Plate Fascia	LF	142	0%	142	\$ -	\$ -	0.000	\$ -	\$ -	\$ -	\$ -	\$ -
16		T&G Soffit w/ Birdscreen Shere Applicable	SF	2325	0%	2325	\$ -	\$ -	0.000	\$ -	\$ -	\$ -	\$ -	\$ -
17		KYNAR Metal Fascia - Metal Wrapped Sub-Fascia & Metal Wrapped 2x Wood Fascia	LF	795	0%	795	\$ -	\$ -	0.000	\$ -	\$ -	\$ -	\$ -	\$ -
<b>Flashing</b>														
18		(2x) Cant Strip	LF	365	0%	365	\$ -	\$ -	0.000	\$ -	\$ -	\$ -	\$ -	\$ -
19		Drip Edge Flashing	LF	290	0%	290	\$ -	\$ -	0.000	\$ -	\$ -	\$ -	\$ -	\$ -
20		KYNAR Metal Drip Edge	LF	430	0%	430	\$ -	\$ -	0.000	\$ -	\$ -	\$ -	\$ -	\$ -
21		Wall Flashing w/ Roofing Wrapped	LF	220	0%	220	\$ -	\$ -	0.000	\$ -	\$ -	\$ -	\$ -	\$ -
22		KYNAR Step Flashing - Color To Match Roofing	LF	220	0%	220	\$ -	\$ -	0.000	\$ -	\$ -	\$ -	\$ -	\$ -
23		Snow Break - Insulated As Required By The Manufacturer	LF	314	0%	314	\$ -	\$ -	0.000	\$ -	\$ -	\$ -	\$ -	\$ -
24		Vertical Wall Flashing To Be KYNAR Finished "Weathered Copper"	LF	30	0%	30	\$ -	\$ -	0.000	\$ -	\$ -	\$ -	\$ -	\$ -
<b>Other's</b>														
25		Roof Circlet	SF	163	0%	163	\$ -	\$ -	0.000	\$ -	\$ -	\$ -	\$ -	\$ -
26		Precast Concrete Chimney Cap - If Required	EA	1	0%	1	\$ -	\$ -	0.000	\$ -	\$ -	\$ -	\$ -	\$ -
27		Coping / Cap, Mounted On Canted Plate	LF	145	0%	145	\$ -	\$ -	0.000	\$ -	\$ -	\$ -	\$ -	\$ -
<b>Subtotal (Thermal &amp; Moisture Protection)</b>													\$ -	\$ -
													<b>PROJECTED COST</b>	\$ -
													<b>INSURANCE</b>	3%
													<b>CONTINGENCY</b>	5%
													<b>OVERHEAD AND PROFIT</b>	15%
													<b>TAX</b>	0.00%
													<b>SUGGESTED BID</b>	\$ -

**Note:**  
 Items and their prices with owner.  
 Prices are used for pricing.  
 depending upon field conditions.



RES23-1605  
REVISED 2

GENERAL ROOF NOTES

1. ALL VISIBLE FLASHING SHALL BE KYNAR FINISHED, WHERE APPLICABLE TO ROOF. PAINTED GALVANIZED MAY BE USED AT GABLE AND EAVE ENDS WHERE SHINGLES WILL COVER EXPOSED FLASHING.
2. RAINOUT FLASHING AND LEAKAGE SHALL BE PREVENTED BY VENTOR SCOURING AND VENTOR TO CONFIRM. VENTOR SIZES AND ANCHOR ARE APPROPRIATE TO PROVIDE A POSITIVE DRAINAGE SYSTEM.
3. ALL EAVE VENT OPENINGS SHALL BE COVERED WITH WIRE MESH AND BRIDSCREEN. EAVEVENT LOCATIONS SHALL BE DETERMINED IN FIELD AND COORDINATE EQUALLY AROUND THE PERIMETER. EAVES PRINT ANY EXPOSED NAILS SEEN THROUGH BRD SCREEN.
4. ALL ROOF ARE NE TREATMENT ARE TO BE FINISHED PAINTED TO MATCH ADJACENT ROOF COLORS.
5. VENTS, EXHAUSTS AND OTHER PIPINGS AND MECHANICAL ROOF PENETRATIONS HAVE NOT BEEN SHOWN EXACT LOCATIONS, TYPES, SIZES AND QUANTITIES MUST BE VERIFIED.
6. ALL FLAT ROOF, ROOF DRAINS AND OVERFLOW DRAINS TO BE CAST IRON AND INSULATED SUBCONTRACTOR TO BE RE-EXAMINE FOR DRAIN MINIMUM 1/4" DIA.
7. VENT DRYERS AND BATHROOM EXHAUST FANS IN SOFFIT PREFERABLY OR SIDE WALL WHERE POSSIBLE. COORDINATE LOCATIONS WITH DESIGNER. SEE AS SHEETS FOR VENT COVERS IN SOFFIT OR SIDE WALL.
8. DIRECT ON OF SLOPE 1/4" MINIMUM LOW SLOPE ROOFS. VERIFY MIN. REQUIRED BY MANUFACTURER.

NOTE:  
SEE AS SHEETS FOR SPECIFIC MATERIALS

KEYED NOTES

1. FULLY ADHESIVE SINGLE PLY ROOFING (GRAY IN COLOR). SLOPE ROOF AT A MINIMUM OF 1/4" R/12. POLYURETHANE INSULATION. PROVIDE POSITIVE DRAINAGE TO DRAINAGE. MINORWARE TO RUN VERTICALLY AS SPECIFIED BY MANUFACTURER. VERIFY AT WORK LOCATIONS, AND OVER THE TOP OF THE PARAPET WALLS.
2. KYNAR FINISHED STANDING SEAM METAL ROOFING ON BUR ROOF FELT AND ICE AND WATER SHIELD AT THE PERIMETER EDGES AND ROOF PLANE INTERSECTIONS. EXTERIOR ICE AND WATER SHIELD AT MAIN PART RIDGE FACE OF EXTERIOR WALL.
3. DETERMINE STRUCTURE BELOW.
4. KYNAR FINISHED FLASHING AND COPING. CAP MOUNTED ON CARVED PLATE. SLOPE TO DRAIN COPING TO HAVE DRAIN EDGE BOTH SIDES.
5. KAL WALL SKIN. QHTS, TYP.
6. IF FOUND KYNAR FINISHED WEATHERED COPPER. GUTTER & CHAIN LEAKERS (SEE AROUND KYNAR FINISHED WEATHERED COPPER DOWNROPS WHEN DRAWING TO ANOTHER ROOF PLANE) SECURELY ANCHOR CHAIN LEAKERS IN THE GROUND. CHAIN LEAKERS INTO BURIED STORMWATER PIPE. USE TO TRANSFER TO MAIN LEAKERS. FIELD VENT.
7. CRICKET MATCH ADJACENT ROOFING MATERIAL.
8. CHIMNEY CAP. PRE-CAST CONCRETE CAP CORNERS. 3/4" ANGLE HEAD. WITH "HANDCHO" 3" WIRE MESH. INSERT 1/2" SQUARE WIRE. FORMER COATED OR TIED TOP TO CONCRETE. PRODUCE SPARK ARRESTOR. PROVIDE ADEQUATE VENTILATION AROUND SPARK ARRESTOR AND FLUE PIPE. PROVIDE KYNAR SHEET METAL PAN WITH DRAIN EDGE LEAD CONCRETE CAP. SLOPE TO DRAIN. PROVIDE WEEP HOLES FOR WATER DRAINAGE IN CONCRETE CAP.
9. WIDE FLANGE BEAM END. PAINTED.
10. VERTICAL WALL FLASHING TO BE KYNAR FINISHED WEATHERED COPPER.
11. DOWNRAIN IS ADSI LOCATION.
12. CUSTOM SQUARE ALUMINUM DOWNPOUT.
13. SNOWBREAK - INSTALLED AS REQUIRED BY THE MANUFACTURER.
14. EXTERIOR STEEL FASCIA AT LOWER TERRACE. SEE DETAIL 2 1/8/2.
15. EXTERIOR STEEL FASCIA AT TERRACE ROOF. SEE DETAIL 1/8/2/2.
16. EXTERIOR STEEL FASCIA AT UPPER TERRACE. SEE DETAIL 2/8/2.
17. KYNAR METAL FASCIA. SEE DETAIL ON AS SHEETS.
18. ROOF DRAIN AND OVERFLOW DRAIN. DRAIN LOCATIONS DRAINS TO BE INSULATED. CAST IRON RUN IN JOIST SPACE. SLOPE AS REQUIRED. 1/4" MIN. VERIFY AND COORDINATE LOCATIONS WITH ROOF AND FLASHING SUBCONTRACTOR. PROVIDE DOWN TONGUE ON OVERFLOW DRAIN. SEE AS SHEETS. PROVIDE COMMERCIAL GRADE HEAT TAPE FOR 4' AROUND DRAINS AND WRAPPED DOWN READERER.
19. LANDMARK ELEVATED LOCKING SYSTEM OR EQUAL. VERIFY WITH ARCHITECT. SEE AS SHEETS.

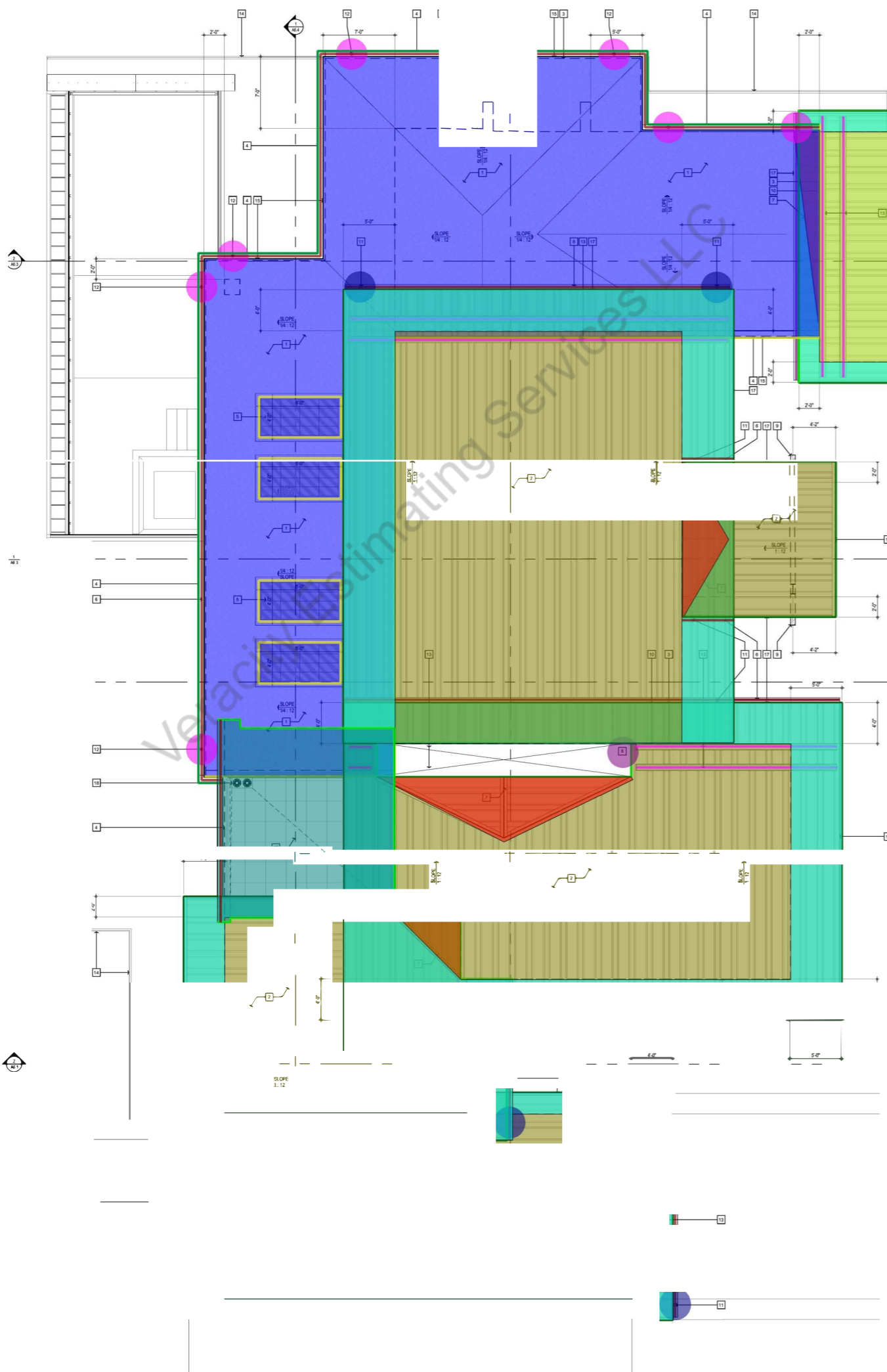

Tag 2	1,942.5 SQ FT	<input type="checkbox"/>
Tag 13	313.7 FT	<input type="checkbox"/>
Tag 11	36.7 FT	<input type="checkbox"/>
Tag 6	189.6 FT	<input type="checkbox"/>
Tag 17 & 36 (A6.3)	793.4 FT	<input type="checkbox"/>
Soffit 30	2,321.0 SQ FT	<input type="checkbox"/>
4 (A6.3)	216.8 FT	<input type="checkbox"/>
34 (gutter)	113.4 FT	<input type="checkbox"/>
Tag 7 Roof Cricket	162.7 SQ FT	<input type="checkbox"/>
Tag 10	26.5 FT	<input type="checkbox"/>
5	219.7 FT	<input type="checkbox"/>
Area	2,087.6 SQ FT	<input type="checkbox"/>
Tag 12	7.0	<input type="checkbox"/>
Tag 4	141.5 FT	<input type="checkbox"/>
Tag 6	140.2 FT	<input type="checkbox"/>
Tag 15	141.5 FT	<input type="checkbox"/>
Tag 2	5,150.6 SQ FT	<input type="checkbox"/>
Tag 11	4.0	<input type="checkbox"/>
8	1.0	<input type="checkbox"/>
19	322.9 SQ FT	<input type="checkbox"/>

**VERACITY ESTIMATING**  
Construction Estimation Services

eric.hedlund@designllc  
po box 3741  
505 n. 4th street, lehigh  
208-778-0065 fax  
info@eh-design.net

RAIRDON  
07.29.24 CONSTRUCTION SET  
DATE: 12.20.23 ISSUED FOR: KOOTENAI COUNTY  
04.19.24 AS-4601  
04.19.24 AS-4602  
06.24.24 AS-4603  
07.29.24 CONSTRUCTION SET  
COPYRIGHT 2024  
ERIC HEDLUND DESIGN, LLC  
ALL RIGHTS RESERVED. REPRODUCTION  
OR TRANSMISSION OF ANY PART OF THE  
INFORMATION CONTAINED HEREIN  
WITHOUT THE WRITTEN PERMISSION  
OF ERIC HEDLUND DESIGN, LLC  
IS STRICTLY PROHIBITED.  
DATE: JULY 28, 2024  
DRAWN BY: JWG  
JOB NUMBER: 12321  
CHECKED BY: ELHRC