

Building Data Summary	
Project ID:	*****
Location:	*****
Scope of Work:	Flooring
Date:	

Item #	Ref. Sheet #	Item Description	Unit	Quantity	Wastage	Quantity w/ Wastage	Unit Material Cost	Total Material Cost	Unit Manhour	Hourly Wage	Unit Labor Cost	Total Labor Cost	Sub Cost	Total Trade Cost
DIVISION.01 GENERAL REQUIREMENTS														
1		Supervision and Coordination	LS	1	0%	1	\$ -	\$ -	0.000	\$ -	\$ -	\$ -	\$ 1,000.00	
2		Submittals and Shop drawings	LS	1	0%	1	\$ -	\$ -	0.000	\$ -	\$ -	\$ -	\$ -	
3		Final Cleaning	LS	1	0%	1	\$ -	\$ -	0.000	\$ -	\$ -	\$ -	\$ 700.00	
4		Mobilization Costs	LS	1	0%	1	\$ -	\$ -	0.000	\$ -	\$ -	\$ -	\$ 1,500.00	
5		Temporary Control & Facilities	LS	1	0%	1	\$ -	\$ -	0.000	\$ -	\$ -	\$ -	\$ 500.00	
		Subtotal (General Requirements)												\$ 3,700

DIVISION 09- FINISHES														
	A1.2	Flooring												
6		Carpet Tile Manuf: J&J Flooring Color: Chemistry	SF	380	5%	399	\$ 6.45	\$ 2,573.55	0.060	\$ 55.00	\$ 3.30	\$ 1,316.70	\$ 3,890.25	
7		Luxury Vinyl Tile J5245 Svannah Walnut Endearing Manuf: Armstrong Parallel	SF	225	5%	236	\$ 3.99	\$ 942.64	0.050	\$ 55.00	\$ 2.75	\$ 649.69	\$ 1,592.33	
8		12"x12" Vinyl Composition Tile Manuf: Armstrong Color: 51810 Washed Linen	SF	1675	5%	1759	\$ 2.34	\$ 4,115.48	0.058	\$ 55.00	\$ 3.21	\$ 5,642.66	\$ 9,758.13	
9		12"x12" Vinyl Composition Tile Manuf: Armstrong Color: 51866 Little Green Apple	SF	160	5%	168	\$ 2.34	\$ 393.12	0.058	\$ 55.00	\$ 3.21	\$ 539.00	\$ 932.12	
10		12"x12" Vinyl Composition Tile Manuf: Armstrong Color: 57517 Bodacious Blue	SF	140	5%	147	\$ 2.34	\$ 343.98	0.058	\$ 55.00	\$ 3.21	\$ 471.63	\$ 815.61	
		Wall Base												
11		(4" H) Rubber Cove Base Manuf: Johnsonite Color: Dark Brown 44	LF	706	5%	741	\$ 1.83	\$ 1,356.58	0.028	\$ 55.00	\$ 1.54	\$ 1,141.60	\$ 2,498.18	
		Transition Strip												
12	Transition Strip Color: #44 Darkbrown	LF	35	5%	37	\$ 3.51	\$ 128.99	0.035	\$ 55.00	\$ 1.93	\$ 70.74	\$ 199.74		
							\$ 9,854				\$ 9,832		\$ 19,686	
												PROJECTED COST	\$ 23,386	
												INSURANCE	3%	\$ 701.59
												CONTINGENCY	5%	\$ 1,169.32
												OVERHEAD AND PROFIT	15%	\$ 3,507.95
												TAX	8.00%	\$ 788
												SUGGESTED BID	\$ 29,554	

Note:

- 1.Please verify the equipment's and their prices with owner.
- 2.Online sources are used for pricing.
- 3.Prices can vary depending upon field conditions.

INTERIOR FINISHES LEGEND

CEILING		
ACT-1	ACOUSTICAL CEILING TILE	ARMSTRONG 2'X2' "FINE FISSURED" #1732 SQUARE EDGE TILE WITH WHITE 15/16" GRID
CARPET		
CPT-1	CARPET TILE	J&J FLOORING, KINETEX, SERIES: CATALYST, COLOR: CHEMISTRY INSTALLATION METHOD: MONOLITHIC
PAINT		
P-1	TYPICAL WALL PAINT	BENJAMIN MOORE: AC-2 "BERKSHIRE BEIGE"; EGG-SHELL FINISH
P-2	ACCENT PAINT	BENJAMIN MOORE: 797 "ATHENS BLUE"; EGG-SHELL FINISH
P-3	ACCENT PAINT	SHERWIN WILLIAMS: SW6422 "SHAGREEN"; EGG-SHELL FINISH
P-4	ACCENT PAINT	BENJAMIN MOORE: HC-173 "EDGE COMB GRAY"; EGG-SHELL FINISH
P-5	TRIM PAINT	BENJAMIN MOORE: HC-173 "EDGE COMB GRAY"; SEMI-GLOSS FINISH
P-6	CEILING PAINT	FLAT FINISH-CEILING PAINT; "CEILING WHITE"
BASE		
RB-1	RUBBER BASE	4" RUBBER BASE, JOHNSONITE; COLOR: DARK BROWN 44; COVE PROFILE

VCT		
LVT-1	LUXURY VINYL TILE	ARMSTRONG PARALLEL J5245: SAVANNAH WALNUT ENDearing
VCT-1	VINYL COMPOSITION TILE	ARMSTRONG: COLOR: 51810 "WASHED LINEN"; SIZE: 12"X12"
VCT-2	VINYL COMPOSITION TILE	ARMSTRONG: COLOR: 57517 "BODACIOUS BLUE"; SIZE: 12"X12"
VCT-3	VINYL COMPOSITION TILE	ARMSTRONG: COLOR: 51866 "LITTLE GREEN APPLE"; SIZE: 12"X12"
PLASTIC LAMINATE		
PL-1	PLASTIC LAMINATE	WILSONART VGP .028 WESTERN SUEDE 4871
PL-2	PLASTIC LAMINATE	WILSONART VGP .028 FROSTY WHITE 1573-60
PL-3	PLASTIC LAMINATE	WILSONART VGP .028 SHAKER CHERRY 7935K-07

INTERIOR FINISH NOTES

- ALL FINISHES SHALL BE INSTALLED ACCORDING TO MANUFACTURERS' INSTRUCTIONS.
- ALL TRANSITION STRIPS SHALL HAVE AN A.D.A. PROFILE AND SHALL BE SUBMITTED TO H+HA FOR APPROVAL.
- SUB- CONTRACTOR MUST SUBMIT PAINT SAMPLES TO ENH FOR APPROVAL.
- FIELD COORDINATE WITH H+HA TO OBTAIN APPROVAL FOR ALL CARPET, TILE, AND VCT FLOORING PATTERNS PRIOR TO INSTALLATION.
- VINYL TRANSITION STRIPS SHALL BE USED AS NEEDED. VINYL TRANSITION STRIP IS TO MATCH RUBBER BASE.
- SCHLUTER TRANSITIONS REQ'D. IN ALL AREAS WHERE CARPET MEETS TILE.
- ALL WALLS TO RECEIVE ONE (1) COAT PRIMER AND TWO (2) COATS EGG-SHELL FINISH LATEX PAINT. PAINTED WOOD AND NOT SHOW ANY TRACES OF WOOD GRAIN AND WOOD PATTERN. PAINT SHALL NOT SHOW ANY SIGNS OF BRUSH.
- CARPET SHALL NOT RECEIVE ANY TRAFFIC FOR 24 HOURS AFTER INSTALLATION. PROVIDE 7% ATTIC STOCK ON ALL.
- BE INSTALLED, CLEANED, STRIPPED AND WAXED PER MANUFACTURER'S RECOMMENDATIONS. FLOORING SHALL NOT AFTER INSTALLATION AND NO HEAVY WEIGHT FOR 48 HOURS.
- ALL WALLS TO BE FINISHED TO LEVEL 4 FINISH.
- GC TO PROVIDE SEAMING DIAGRAMS TO H+HA FOR APPROVAL AT ALL LOCATIONS THAT ARE TO RECEIVE WALLCOVERING OR PLASTIC LAMINATE FINISH.
- PROVIDE 3MM EDGE BANDING FOR ALL COUNTERTOPS.

FINISH SCHEDULE

RM NO	ROOM NAME	FLOOR FINISH	WALL FINISH	BASE	CEILING MATL	COUNTER	CABINET	NOTES
FIRST FLOOR								
101	COFFEE BAR	LVT-1	P-1/P-2	RB-1	P-2	PL-1	PL-3	SEE A1.2 FOR VCT & ACCENT PAINT LOCATION
102	WAITING	LVT-1/CPT-1	P-1/P-3	RB-1				SEE A1.2 FOR VCT & ACCENT PAINT LOCATION
103	RESTROOM	LVT-1	P-1	RB-1		PL-1	PL-2	
104	WORK	VCT-1	P-1	RB-1		PL-1	PL-2	
105		VCT-1	P-1	RB-1		PL-1	PL-2	
106	DRUG SCREEN RR	VCT-1	P-1	RB-1		PL-1	PL-2	
107	LAB	VCT-1				PL-1	PL-2	
108	EXAM	VCT-1/2				PL-1	PL-2	SEE A1.2 FOR VCT & ACCENT PAINT LOCATION
109	OFFICE	VCT-1/3	P-1/P-3	RB-1	ACT-1	PL-1	PL-2	SEE A1.2 FOR VCT & ACCENT PAINT LOCATION

FINISH NOTES:

- FLOOR TILES (CARPET AND VCT) ARE TO BE INSTALLED AS INDICATED ON PLAN WITH FULL TILES WHEREVER POSSIBLE. SEE FINISH SCHEDULE FOR SPECIFICATIONS.
- SEE FINISH SCHEDULE ON SHEET A1.2. FOR SPECS OF ALL FINISHES.
- TILE TRANSITIONS BETWEEN ROOMS TO BE CENTERED UNDER CLOSED DOOR.
- COORD. MILLWORK AND PLUMBING FIXTURE W/ FLOORING SCOPE AS REQ'D.
- PROVIDE ALL FLOORING LAYOUTS FOR H+HA'S REVIEW AND APPROVAL PRIOR TO INSTALLATION.
- PREP FLOOR APPROPRIATELY (RE: PRODUCT MANUFACTURERS STANDARDS) PRIOR TO FLOOR COVERING INSTALLATION.

FINISH KEY NOTES:

378.7 SQ FT

223.7 SQ FT

1,673.3 SQ FT

138.8 SQ FT

160.1 SQ FT

33.6 FT

705.4 FT



LVT-1

Carpet Tile

Luxury Vinyl Tile J5245 Svannah Walnut Endearing

12"x12" Vinyl Composition Tile

12"x12" Vinyl Composition Tile

12"x12" Vinyl Composition Tile

Transition Strip

4" Rubber Cove Base

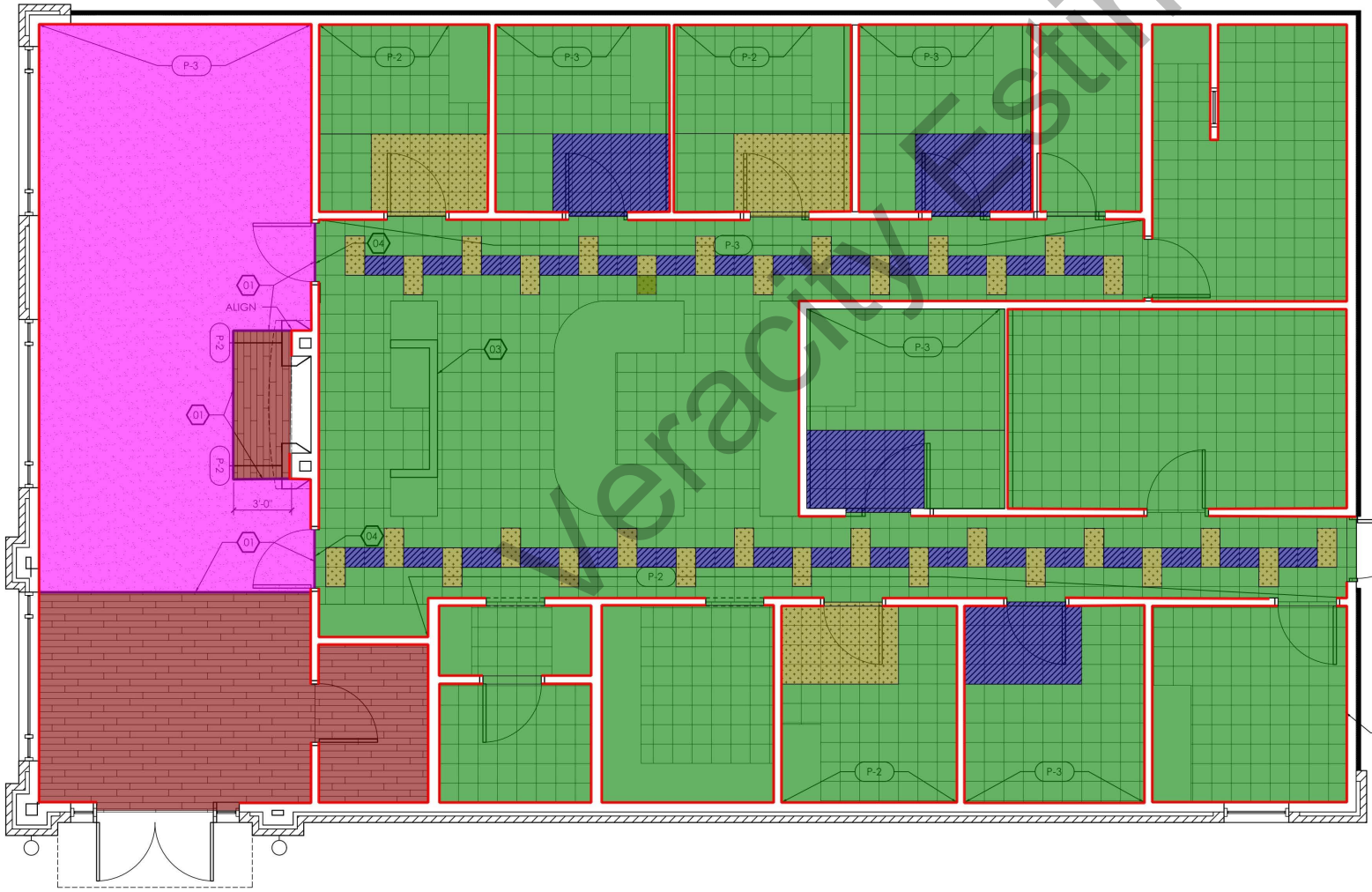

A N w Buid ng F

RELEASES / DESCRIPTION / DATES

NOT FOR CONSTRUCTION  
RELEASED FOR CONSTRUCTION

DATE 11.06.2024  
DRAWN MEH  
CHECKED ENH  
APPROVED H+HA

PROJECT NUMBER 24001.15

SHEET TITLE  
FINISH FLOOR PLAN

DRAWING NO

A1.2

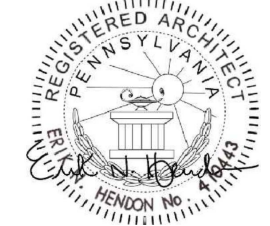

erik n. hendon architect, AIA  
architecture . planning . interior design  
2124 Morris Avenue  
Birmingham, Alabama 35203  
Phone (205) 322-1751  
Fax (205) 322-1778  
email info@hclusha.com  
www.hclusha.com